

COMET RANGE

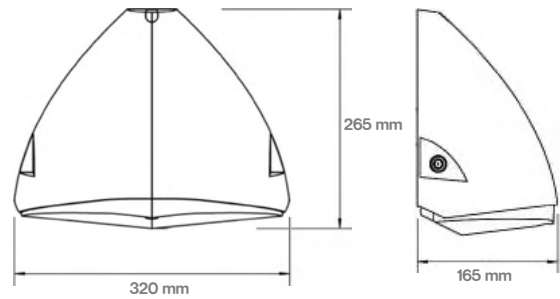

IP65
 IK10
 L80/B10
 50,000 hrs

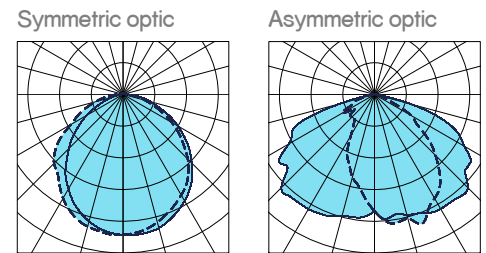

The Comet range incorporates a powder-coated cast aluminium wall mount body and polycarbonate diffuser which is available with a symmetrical optic or an asymmetric optic.

Supplied as standard with switchable CCT LED array, you can choose between 3000K and 4000K, and switchable power output from 13W to 28W. The emergency range of the Comet are fitted with the latest lithium iron phosphate LiFePO4 battery technology, which has a 3-year battery warranty.

The Comet range seamlessly integrates with SCC's standard options, offering choices such as dimmable functionality and emergency configurations. Additionally, these luminaires can be seamlessly integrated into our intelligent lighting systems through wireless options, ushering in a new era of versatile illumination solutions.

Part code	Optic	Power W	Output lm	CCT K	Length mm	Height mm	Depth mm
LUXCOM/SY/CCT	Symmetrical	13 - 28	1700 - 3500	3000/4000	320	265	165
LUXCOM/AS/CCT	Aymmetrical						

DD = DALI Dimmable
 E = Emergency
 BL = Black finish

SD = SwitchDim
 ST = Self Test Emergency
 GR = Grey finish

MD = Mymesh Dim
 ME = Mymesh Emergency
 PC = Photocell

CD = Casambi Dim
 SL** = Slave
 MW = Microwave sensor